

Accessories

Kromer swivel

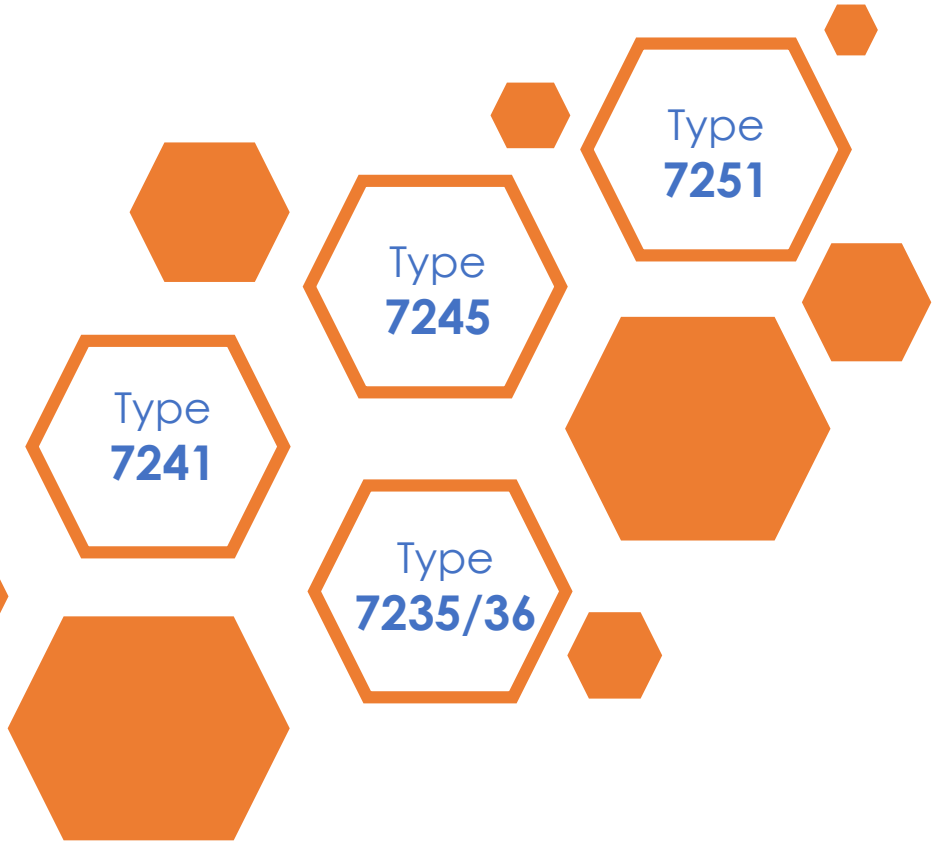

ID no. 007.415 003



Content

1. Brief description
2. How the swivel works
3. Installation of the swivel
4. Customer benefits
5. Special swivel: Insulated version
6. Contact and support

1. Brief description

The Kromer swivel

The swivel serves as an add-on which is placed between the balancer and the attached tool. The swivel has an integrated ball bearing which ensures smooth rotation and improves the handling of the attached tool.

- Load capacity: Max. 200 kg
- Integrated ball bearing
- Less wear on cable and suspension

The Kromer swivel suits to the following Types:
7235/36, 7241, 7245, and 7251.

Article ID: **007.415 003**



Swivel by Kromer

2. How the swivel works

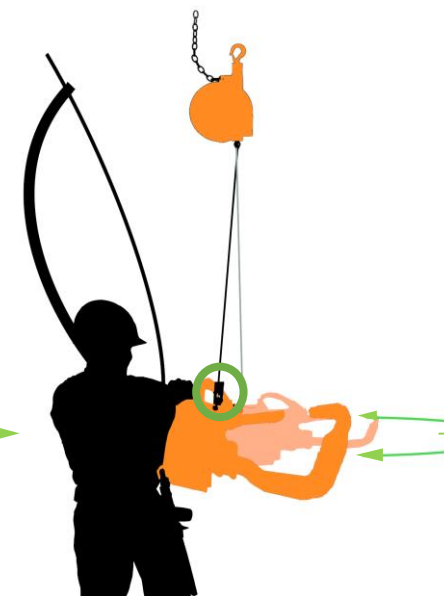
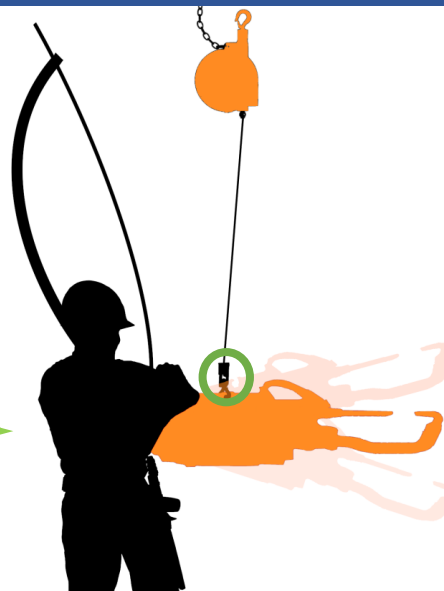

3. Installation of the swivel

How to install the swivel correctly:

1. Release the clamp:

You can use [a pliers](#) to get the clamp out easier:

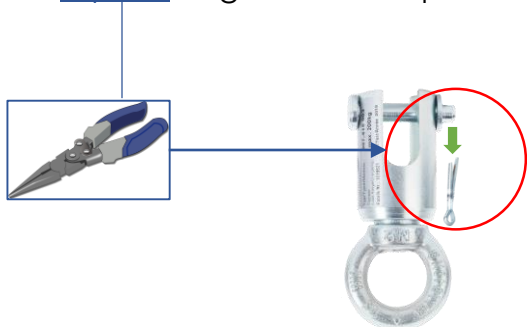

2. Remove the disc from the bolt and the bolt itself:

Now the swivel is ready to be attached to the balancer.

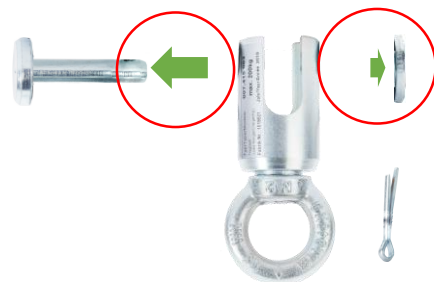

3.



4.



5.

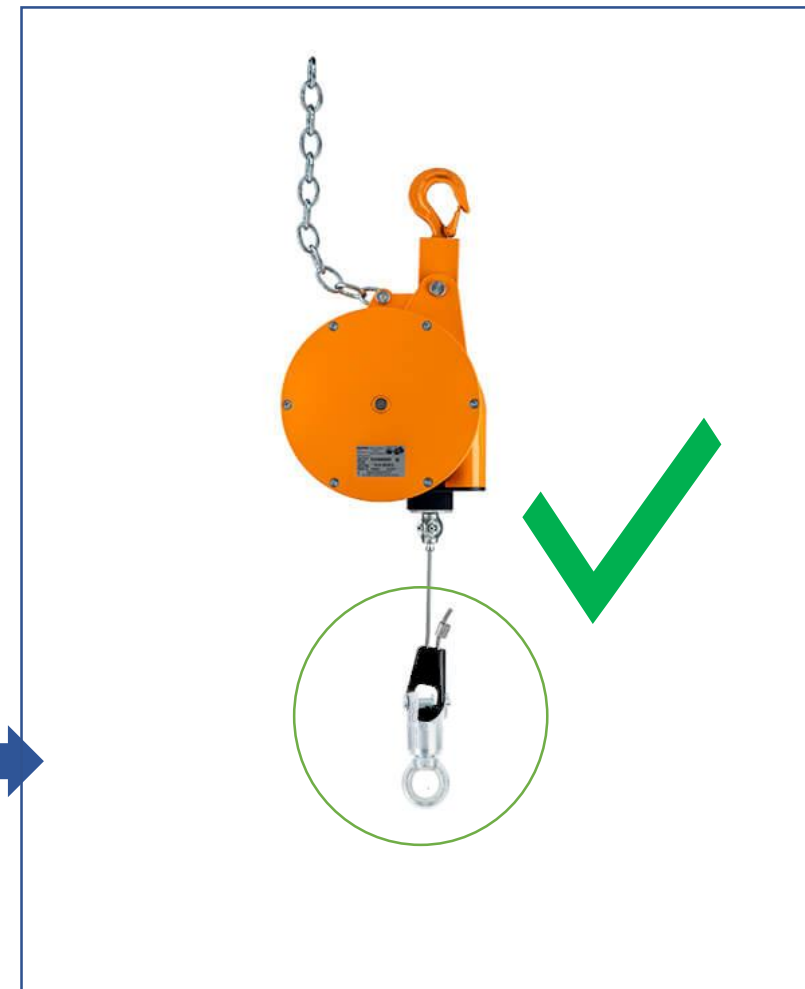

4. Customer Benefits

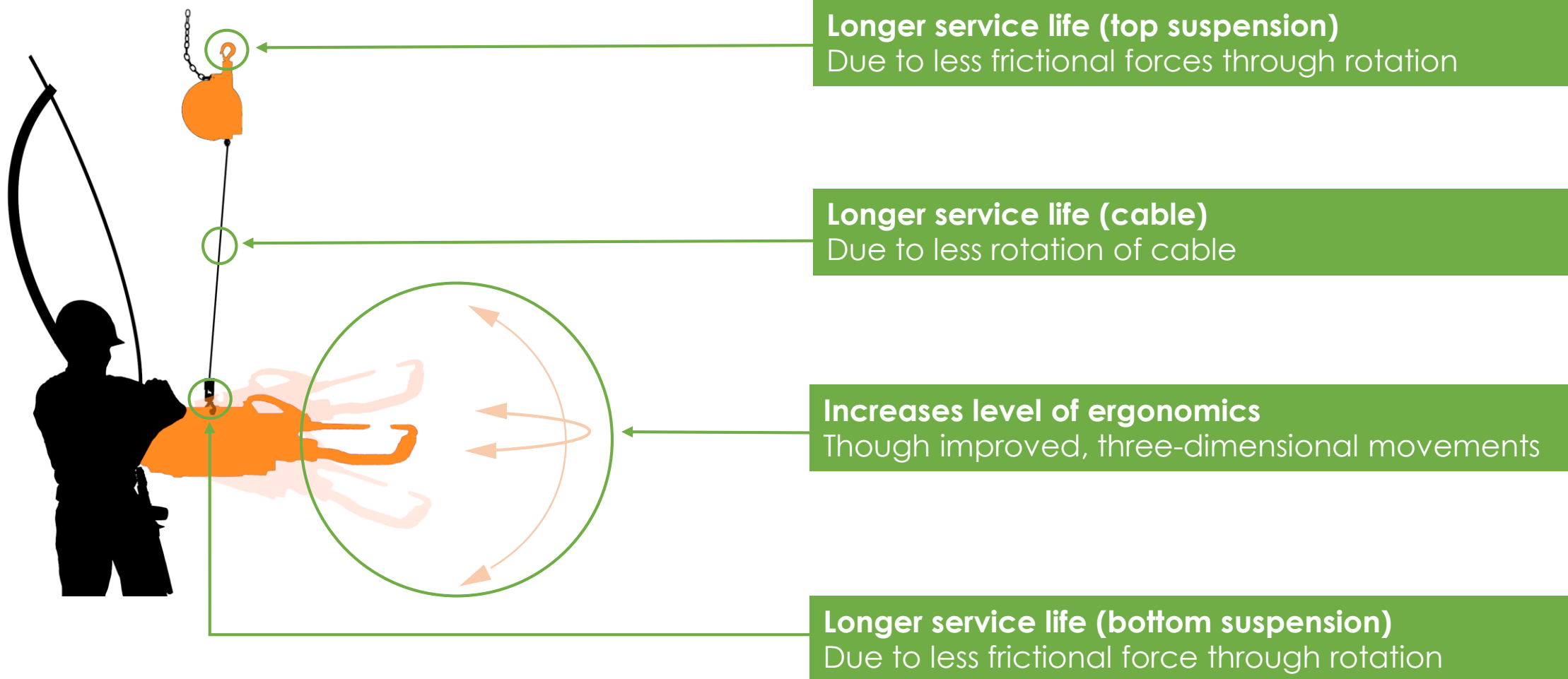

5. Special swivel: Insulated version

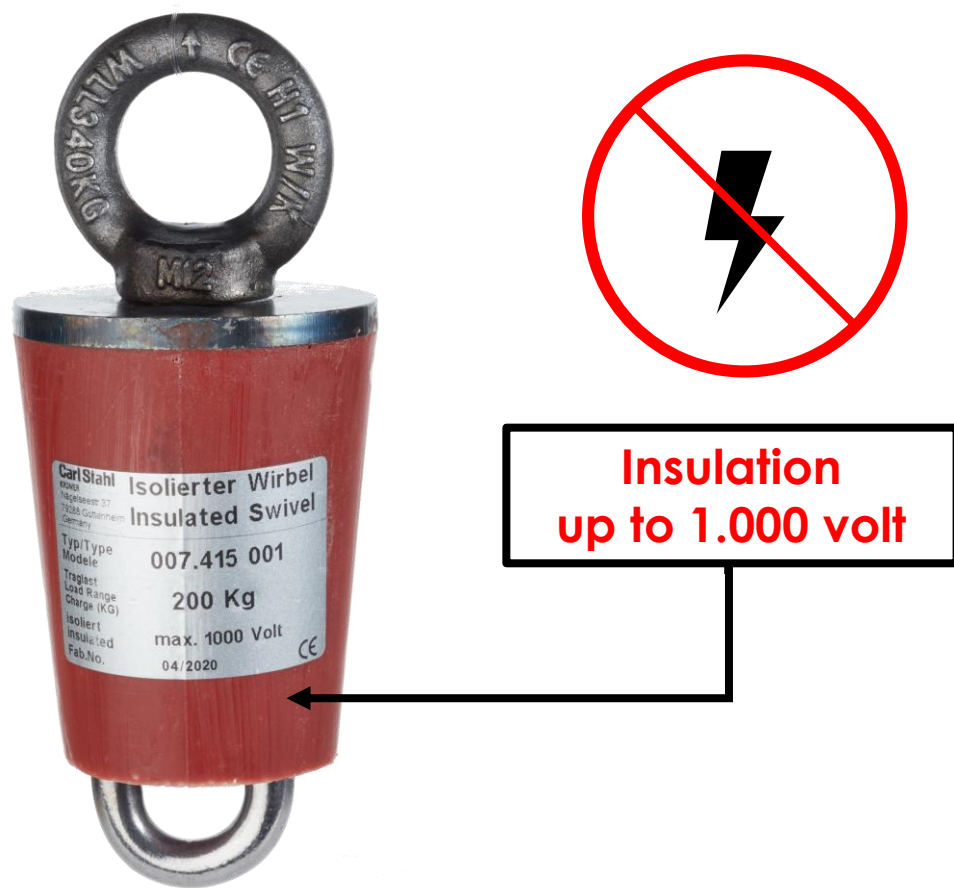

- Insulation up to 1.000 volt
- Load capacity: Max. 200 kg
- Integrated ball bearing
- Less wear on cable and suspension

The insulated swivel suits to:
Kromer Type 7235/36, 7241, 7245 and 7251

Article ID: 007.415 001

This might be also interesting for you:

- **Kromer Download Area:** User manuals, catalogs, technical drawings and more: [click here](#).
- **Kromer Service videos:** Cable replacement, Adjustment of suspension and more: [click here](#).

Further questions?

Do not hesitate to contact us:



+49(0) 7665 50207 - 0



kromer@kromer.com



www.kromer.com



Contact us for a live e-meeting